

SECTION THROUGH RAISED 8'-0" WIDE MAN DOOR
1/4"=1'-0" (S001)

- INSTALLATION SEQUENCES**
1. ALONG GRID LINE F2, CREATE 10"x16" POCKETS IN EXIST. BLOCK WALL.
 2. REMOVE EXIST. MASONRY TO UNDERSIDE OF EXIST. STEEL BEAM.
 3. SCORE MASONRY ALONG GRID LINE F3 ON INTERIOR AND INSTALL L-8"x4"x1/2" LINTEL.
 4. INSTALL 2-L's 5"x5"x1/2" LINTEL AND REBUILD MASONRY WALL ALONG GRID LINE F2.
 5. SCORE MASONRY ON EXTERIOR ALONG GRID LINE F3 AND INSTALL L-8"x4"x1/2" LINTEL.
 6. WELD 3/4" x 8" LONG STEEL PLATES @ 16" C/C TO BOTTOM OF STEEL ANGLES AS SHOWN.

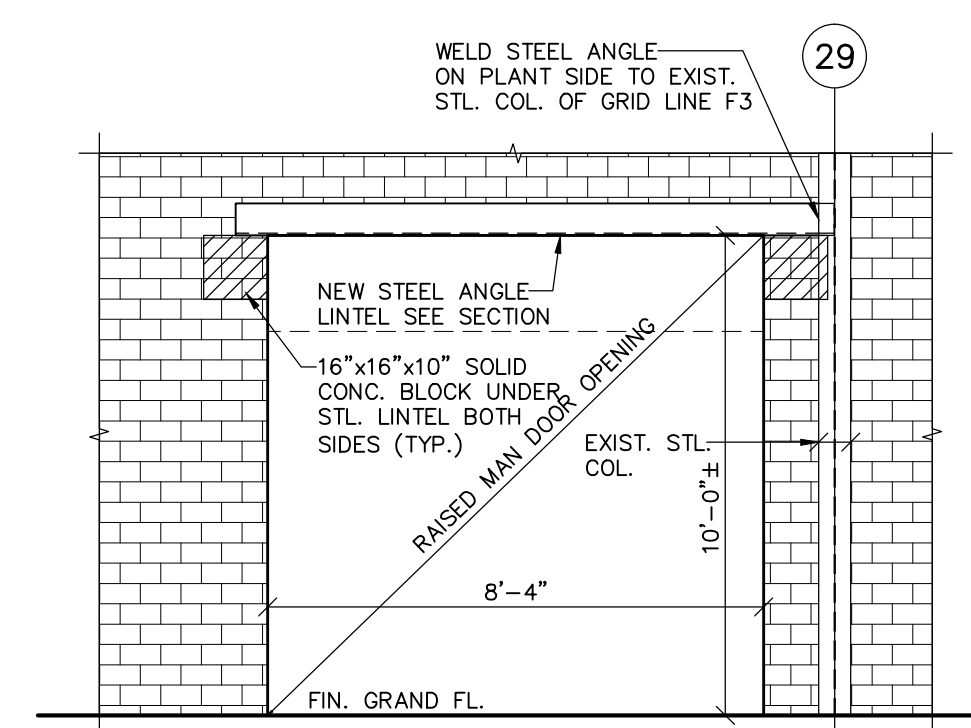

ELEVATION AT RAISED PAIR OF MAN DOORS
1/4"=1'-0" (S001)

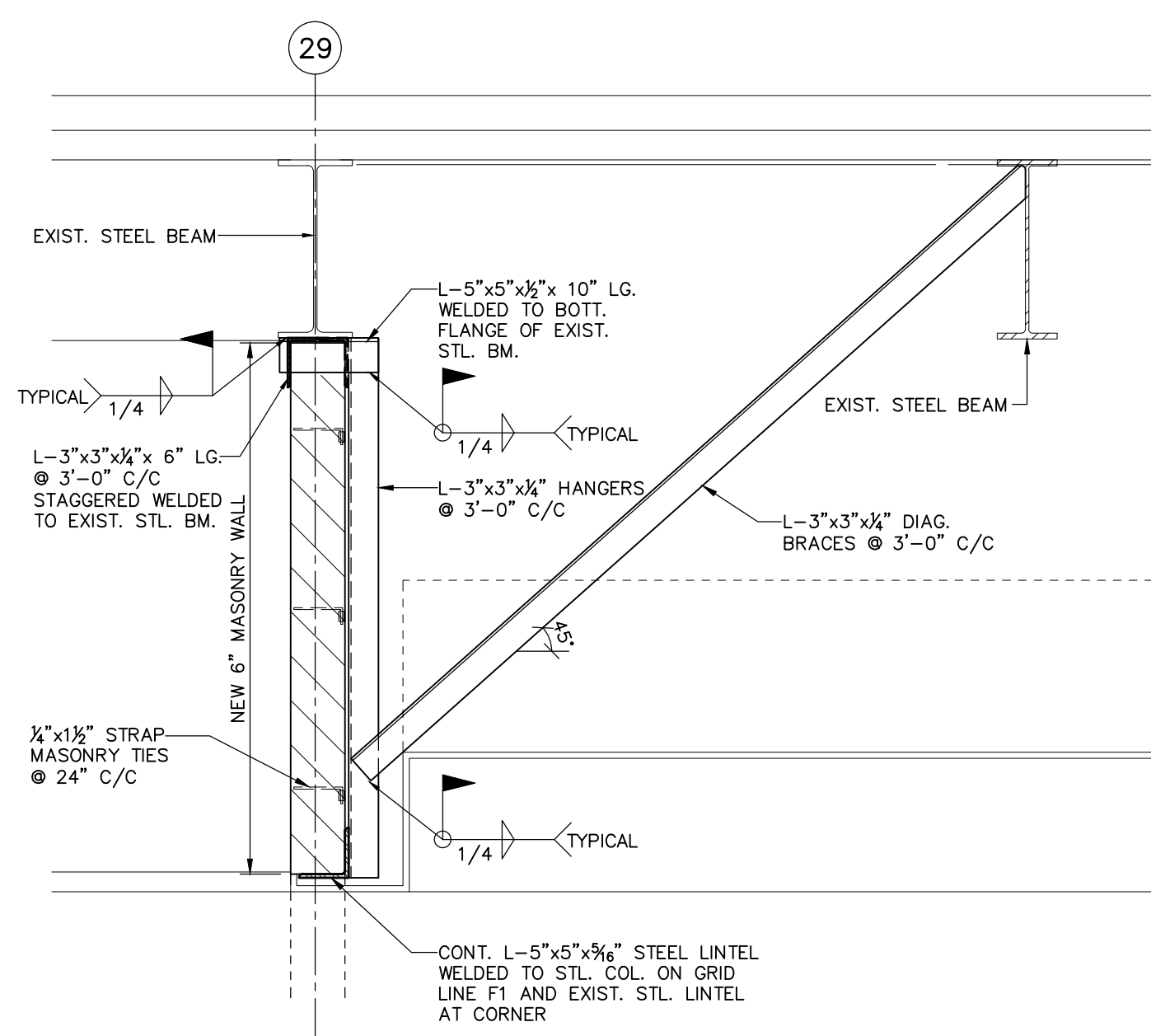

SECTION THROUGH NEW BLOCK WALL IN DISPLAY CENTRE
1/4"=1'-0" (S001)

GENERAL NOTES:

1. READ STRUCTURAL DRAWINGS IN CONJUNCTION WITH ARCHITECTURAL DRAWINGS.
2. REFER TO ARCHITECTURAL DRAWINGS FOR ALL BAY DIMENSIONS.
3. PRIOR TO FABRICATION, SUBMIT WHITE PRINTS (HARD COPIES) OF ERECTION AND SHOP DRAWINGS. DRAWINGS SHALL BE TO A SCALE SUFFICIENTLY LARGE TO CLEARLY SHOW DETAILS. CLEARLY INDICATE ALL STIFFENERS, CUTS, CONNECTIONS, HOLES, THREADED FASTENERS AND WELDS. USE AWS WELDING SYMBOLS.
4. THE ENGINEER'S REVIEW OF THE SHOP DRAWINGS DOES NOT RELIEVE THE CONTRACTOR OF RESPONSIBILITY FOR CONFORMITY TO THE CONTRACT DOCUMENTS. CORRECT DETAILS AND FIT OF MEMBERS AND PARTS. ALL SHOP DRAWINGS SHALL BE STAMPED AND SEALED BY A PROFESSIONAL ENGINEER OF ONTARIO.

STRUCTURAL STEEL NOTES:

1. ALL STRUCTURAL STEELS TO BE NEW MATERIAL CONFORM TO CAN/CSA-C40.21 GRADE 300W.
2. FABRICATION AND ERECTION OF ALL STRUCTURAL STEEL SHALL CONFORM TO CAN/CSA-S16.1 (LATEST EDITION).
3. PROVIDE SUFFICIENT TEMPORARY BRACING TO KEEP STRUCTURAL STEEL FRAME SAFELY PLUMB AND IN TRUE ALIGNMENT DURING CONSTRUCTION.
4. ALL BOLTS SHALL BE ASTM A325 HIGH STRENGTH BOLTS. ANCHOR BOLTS TO BE ASTM A307.
5. ALL WELDS SHALL CONFORM TO CSA STANDARD W59 AND W47.1. ALL WELDS TO BE 1/4" UNLESS OTHERWISE NOTED.
6. ALL STRUCTURAL STEEL SHALL BE PRIMED & FIELD TOUCHED-UP WITH PRIMER PAINT CONFORMING TO GISC/CPMA STANDARD 1-750 OR TO C.G.S.B. STANDARD 1-QP-400.
7. MATERIAL AND CONSTRUCTION SHALL CONFORM TO CURRENT EDITION OF ONTARIO BUILDING CODE UNLESS NOTED OTHERWISE.

NO.	ISSUE	DATE
1	ISSUED FOR PERMIT/CONSTRUCTION	2016-11-10
NO.	REVISIONS	DATE

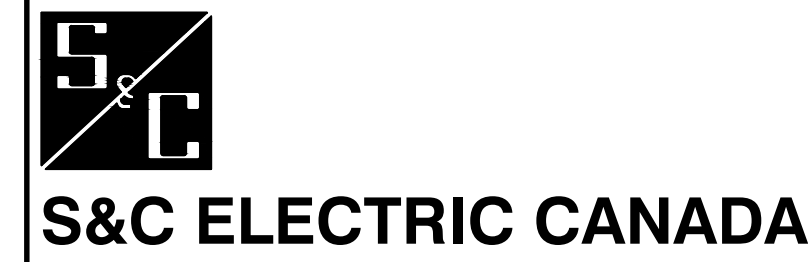

ELEVATION AND SECTIONS OF RAISED PAIR OF MAN DOORS

Project Title
PRODUCT DISPLAY CENTRE, BLDG. 4 RENOVATION
 90 BELFIELD ROAD TORONTO

ZARETSKY CONSULTING ENGINEERS INC.
 25 VALLEYWOOD DR. MARKHAM, ONTARIO L3R 5L9
 TEL: (905) 470-1080 FAX: (905) 470-0598



Approved O.Z.	Checked O.Z.	Drawn By M.C.
Scale AS NOTED	Date OCTOBER, 2016	File No. 16-130
Drawing Number PDC-S-001		Revision Number -