

The contractor shall check all dimensions and other data from the job and report any discrepancies to the architects before proceeding. Do not scale drawing.

1	ISSUED FOR SPA-1	2015-06-10
2	ISSUED FOR SPA-2	2015-08-14
3	ISSUED FOR BUILDING PERMIT	2016-03-02
4	ISSUED FOR TENDER	2016-05-05
5	ISSUED FOR CONSTRUCTION	2016-06-22
6	RE-ISSUED FOR BUILDING PERMIT	2016-07-29

NO.	REVISIONS	DATE
1	ELEC. ROOM ADDED PER HYDRO REQUEST	2016-07-29

LEGEND:

- F1 600 X 600 FLUORESCENT LIGHT FIXTURE
- 01 EXTERIOR POT LIGHT
- 02 POT LIGHT
- W2 WALL MOUNTED LIGHT FIXTURE
- W3 WALL MOUNTED LIGHT FIXTURE
- X SUPPLY AIR DIFFUSER
- R RETURN AIR GRILLE
- F EXHAUST FAN
- UH UNIT HEATER

NOTES:

1. REFER TO MECHANICAL DRAWINGS FOR ALL MECHANICAL ITEMS.
2. REFER TO ELECTRICAL DRAWINGS FOR ALL ELECTRICAL ITEMS.
3. DO ALL WORK IN ACCORDANCE WITH ESA AND APPLICABLE CODES.

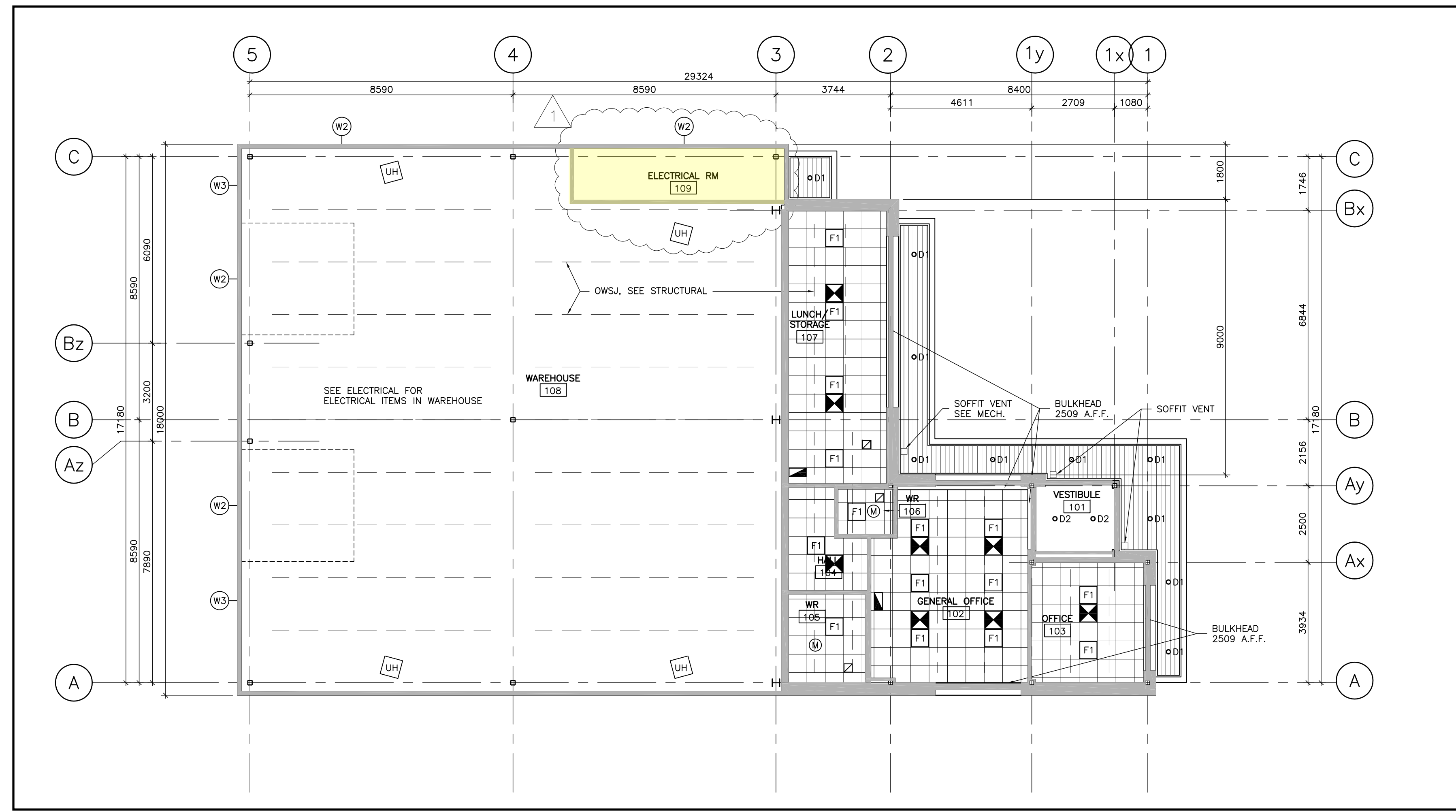

1 REFLECTED CEILING PLAN
1:100

Owner
S. ACTON HOLDINGS LTD.
905 338 9253

Drawing Title
REFLECTED CEILING PLAN

Project Title
NEW WAREHOUSE

1340 HEINE COURT BURLINGTON

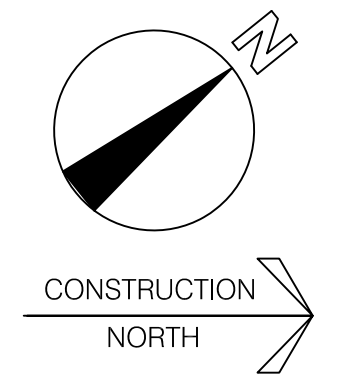

Donald J. Caunter
Architect Limited

40 St. Clair Ave. East, Suite 302, Toronto, ON M4T 1M9 (416) 922-2040

Approved	DJC	Checked	DJC	Drawn By	WT
Scale	1:100	Date	2015-03-16	File No.	116903

Drawing Number	A-104	Revision Number	R1
----------------	-------	-----------------	----